

smartwin solar EIFS concrete (WDVS Beton)



U_{1D} Wall	0,167	W/m²K
U_{2D} Window	0,765	W/m²K
U_{2D}	0,299	W/m²K

Length S1	1,500	m
Length S2	0,400	m
Total length	1,900	m

L_{1D}	0,556	W/mK
L_{2D}	0,567	W/mK

Ψ_e	0,012	W/mK
----------	-------	------

projected X
projected X

PHI				
Boundary Conditions	R_s	θ	R_s	θ
	0,13	20,00	0,25	20,00
	0,13	20,00	0,20	20,00
	0,04	-10,00	0,04	-10,00
Psi-value			fR_{si}	

lowest interior temperature:
 f_{Rsi} at 20 °C / -10 °C

12,7°C
0,76 > 0,7 requirement fulfilled

Isotherms:

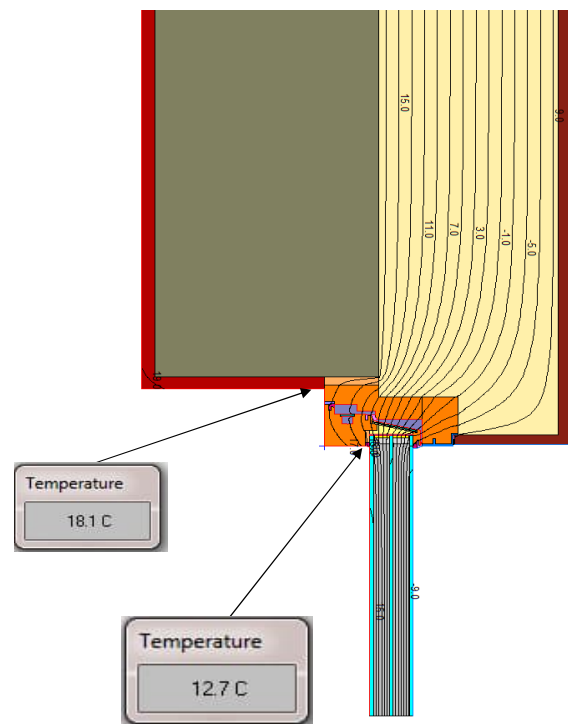
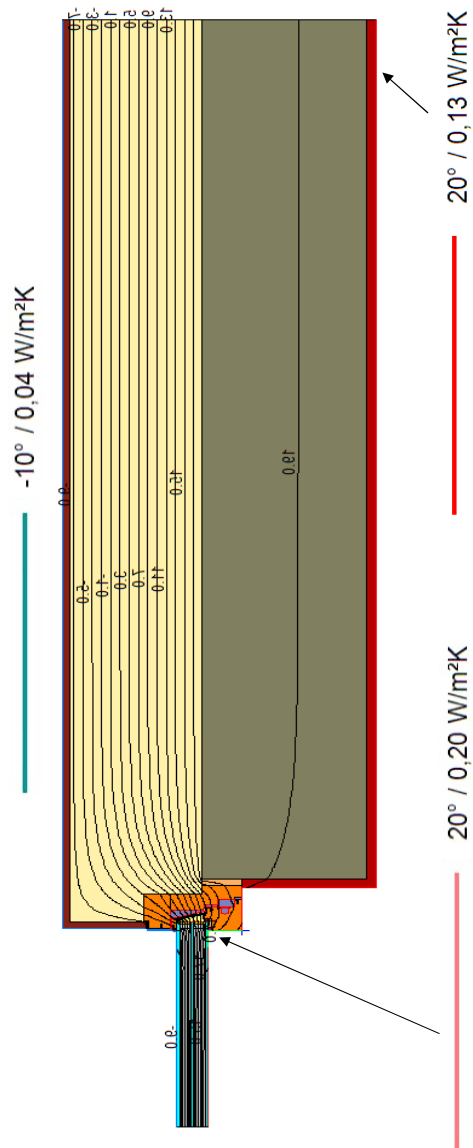

Date	31.07.2018
Signature	

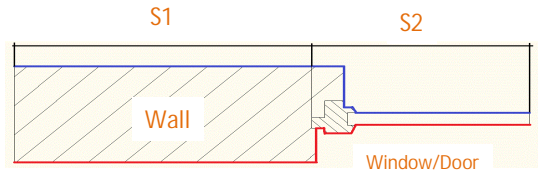

smartwin solar EIFS concrete (WDVS Beton) blindframe (Blindstock)



U_{1D} Wall	0,167	W/m ² K
U_{2D} Window	0,765	W/m ² K
U_{2D}	0,302	W/m ² K

Length S1	1,500	m
Length S2	0,400	m
Total length	1,900	m

L_{1D}	0,556	W/mK
L_{2D}	0,574	W/mK

Ψ_e	0,018	W/mK
----------	-------	------

projected X
projected X

PHI				
Boundary Conditions	R_s	θ	R_s	θ
	0,13	20,00	0,25	20,00
	0,13	20,00	0,20	20,00
	0,04	-10,00	0,04	-10,00
Psi-value			f_{Rsi}	

lowest interior temperature:
 f_{Rsi} at 20 °C / -10 °C

13,0°C
0,77

> 0,7 requirement fulfilled

Isotherms:

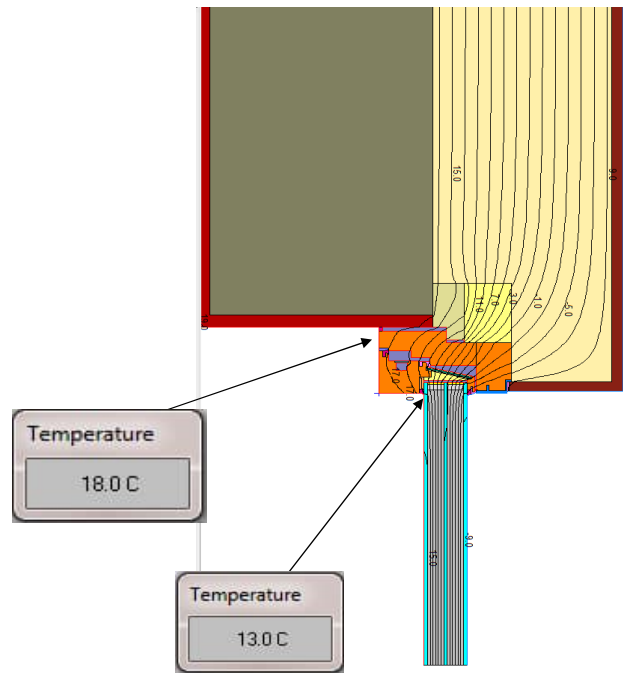
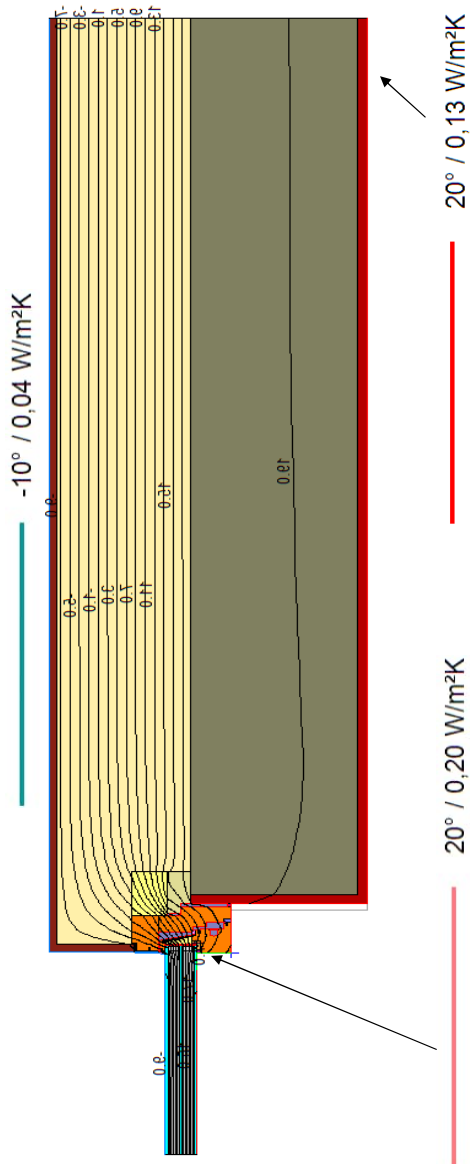

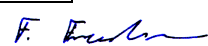
Date	31.07.2018
Signature	

smartwin solar EIFS concrete (WDVS Beton)
venetian blind (Rafflamelle)



U_{1D} Wall	0,167	W/m ² K
U_{2D} Window	0,756	W/m ² K
U_{2D}	0,330	W/m ² K

Length S1	1,500	m
Length S2	0,400	m
Total length	1,900	m

L_{1D}	0,552	W/mK
L_{2D}	0,627	W/mK

Ψ_e	0,075	W/mK
----------	-------	------

projected X
projected X

PHI				
Boundary Conditions	R_s	θ	R_s	θ
	0,13	20,00	0,25	20,00
	0,13	20,00	0,20	20,00
	0,04	-10,00	0,04	-10,00
Psi-value			fR_{si}	

lowest interior temperature:
 f_{RSI} at 20 °C / -10 °C

12,5°C
0,75

> 0,7 requirement fulfilled

Isotherms:

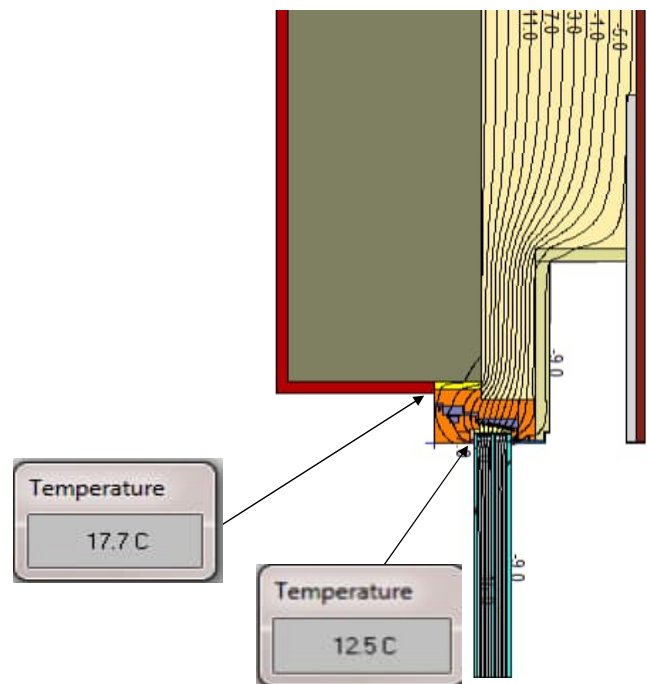
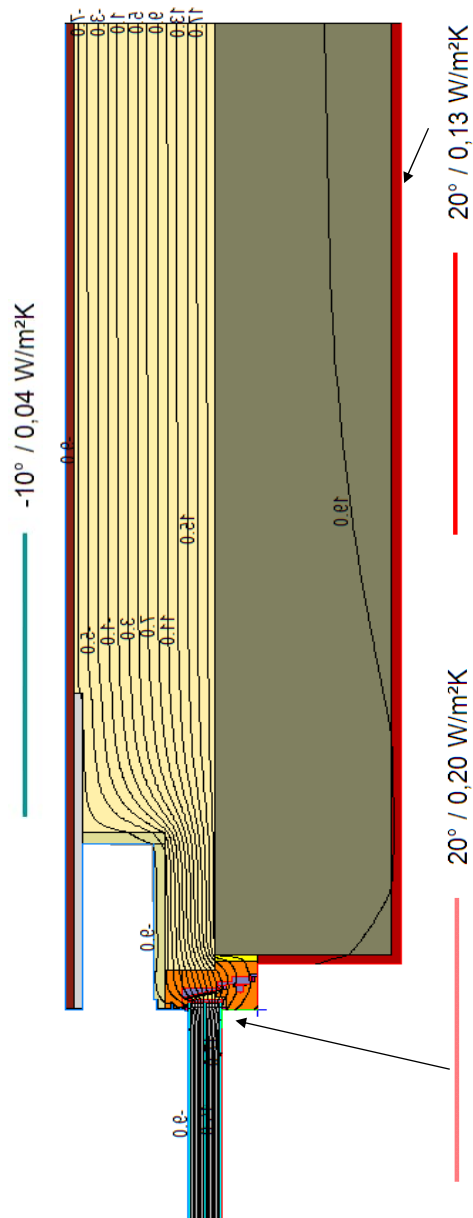

Date	01.08.2018
Signature	

smartwin solar EIFS concrete (WDVS Beton)
venetian blind (Rafflamelle)
variant with PU



U_{1D} Wall	0,167	W/m ² K
U_{2D} Window	0,756	W/m ² K
U_{2D}	0,308	W/m ² K

Length S1	1,500	m
Length S2	0,400	m
Total length	1,900	m

L_{1D}	0,552	W/mK
L_{2D}	0,584	W/mK

Ψ_e	0,032	W/mK
----------	-------	------

projected X
projected X

PHI				
Boundary Conditions	R_s	θ	R_s	θ
	0,13	20,00	0,25	20,00
	0,13	20,00	0,20	20,00
	0,04	-10,00	0,04	-10,00
Psi-value			fR_{si}	

lowest interior temperature:
 f_{RSI} at 20 °C / -10 °C

12,5°C
0,75 > 0,7 requirement fulfilled

Isotherms:

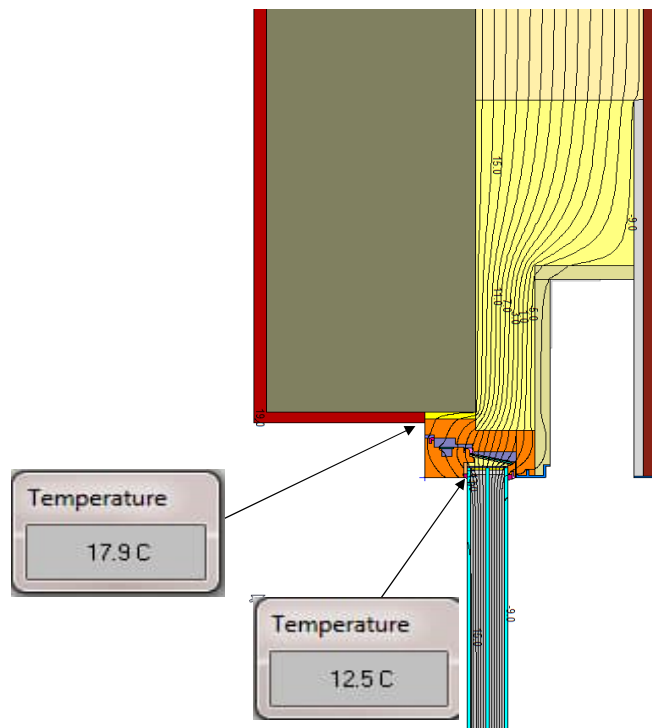
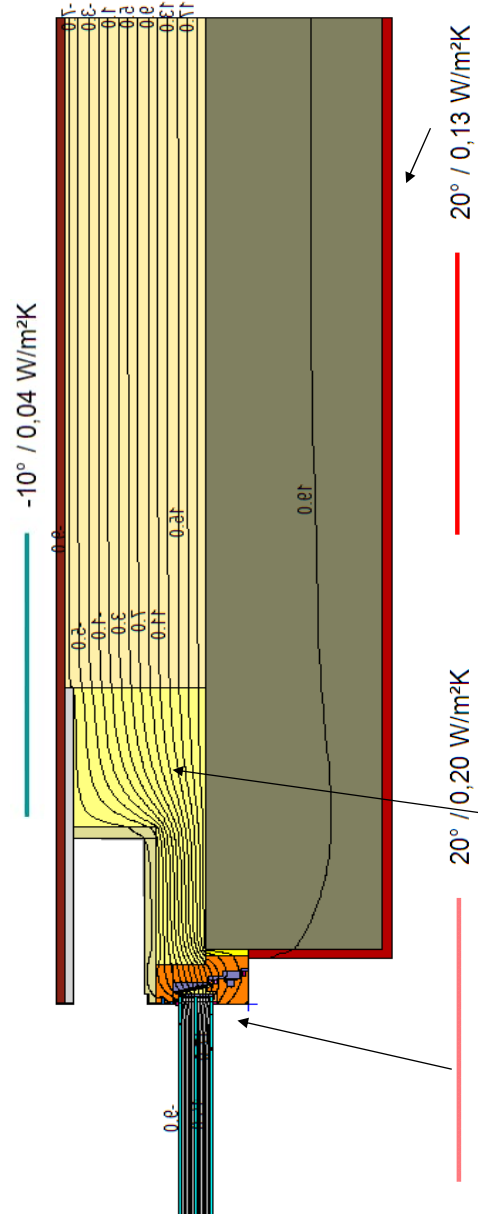

Temperature
17.9 C

Temperature
12.5 C

Properties for Selected Polygon(s)

Material:

ID:

Conductivity: W/m-K

Emissivity:

OK Cancel Library

smartwin solar EIFS concrete (WDVS Beton)
venetian blind (Rafflamelle) blindframe (Blindstock)



U_{1D} Wall	0,167	W/m ² K
U_{2D} Window	0,756	W/m ² K
U_{2D}	0,337	W/m ² K

Length S1	1,500	m
Length S2	0,400	m
Total length	1,900	m

L_{1D}	0,552	W/mK
L_{2D}	0,640	W/mK

Ψ_e	0,088	W/mK
----------	-------	------

projected X
projected X

PHI				
Boundary Conditions	R_s	θ	R_s	θ
	0,13	20,00	0,25	20,00
	0,13	20,00	0,20	20,00
	0,04	-10,00	0,04	-10,00
Psi-value			fR_{si}	

lowest interior temperature:
 f_{RSI} at 20 °C / -10 °C

12,5°C
0,75

> 0,7 requirement fulfilled

Isotherms:

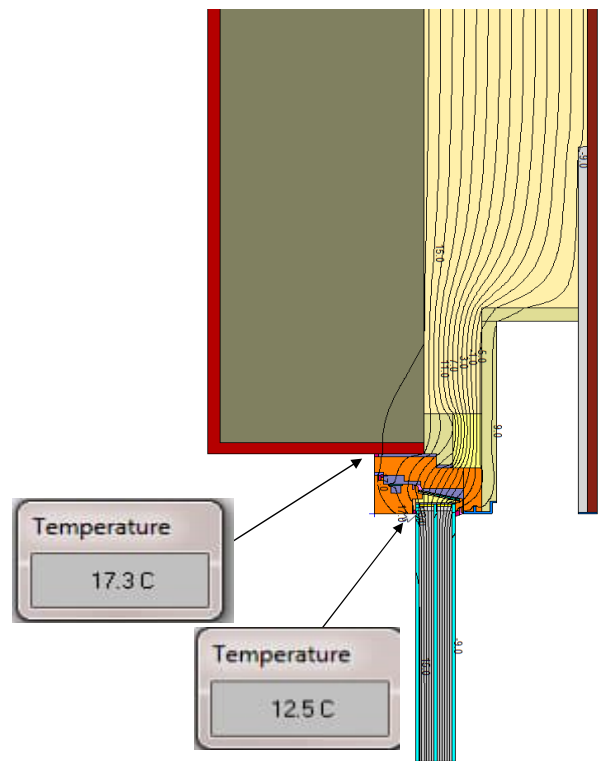
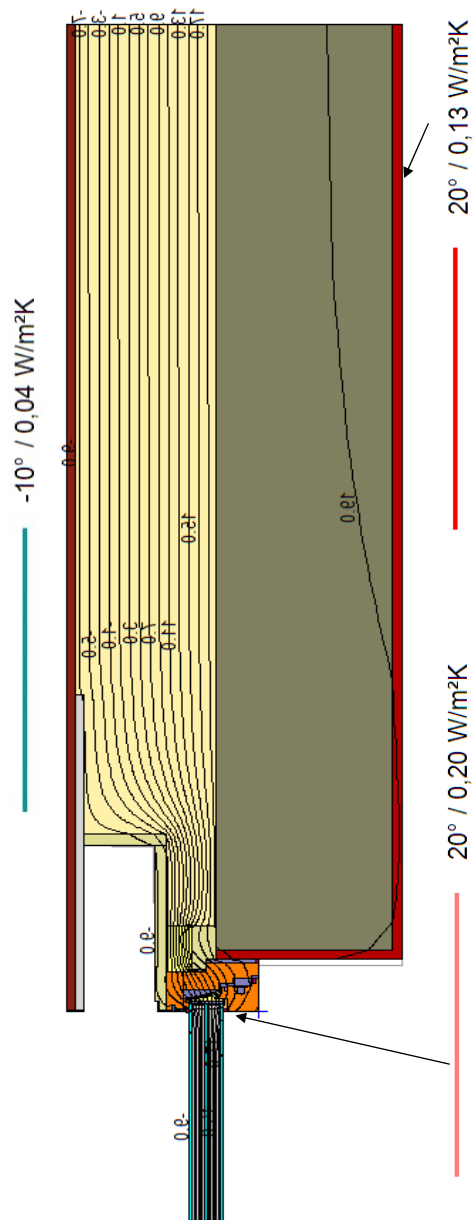

Date	01.08.2018
Signature	

smartwin solar EIFS concrete (WDVS Beton)
venetian blind (Rafflamelle)



U_{1D} Wall	0,167	W/m²K
U_{2D} Window	0,756	W/m²K
U_{2D}	0,299	W/m²K

Length S1	1,500	m
Length S2	0,400	m
Total length	1,900	m

L_{1D}	0,552	W/mK
L_{2D}	0,568	W/mK

Ψ_e	0,015	W/mK
----------	-------	------

projected X
projected X

PHI				
Boundary Conditions	R_s	θ	R_s	θ
	0,13	20,00	0,25	20,00
	0,13	20,00	0,20	20,00
	0,04	-10,00	0,04	-10,00
Psi-value			fR_{si}	

lowest interior temperature:
 f_{RSI} at 20 °C / -10 °C

12,7°C
0,76

> 0,7 requirement fulfilled

Isotherms:

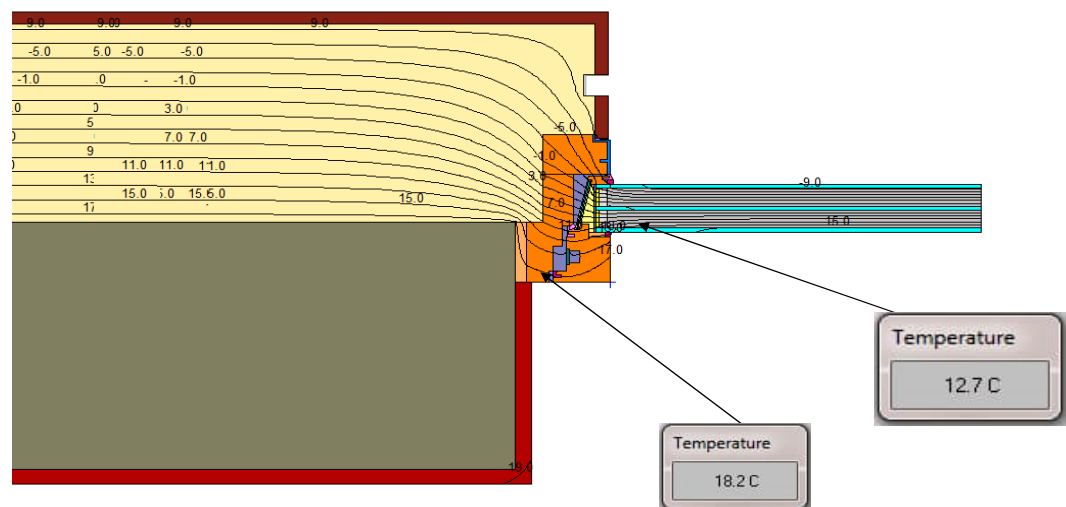
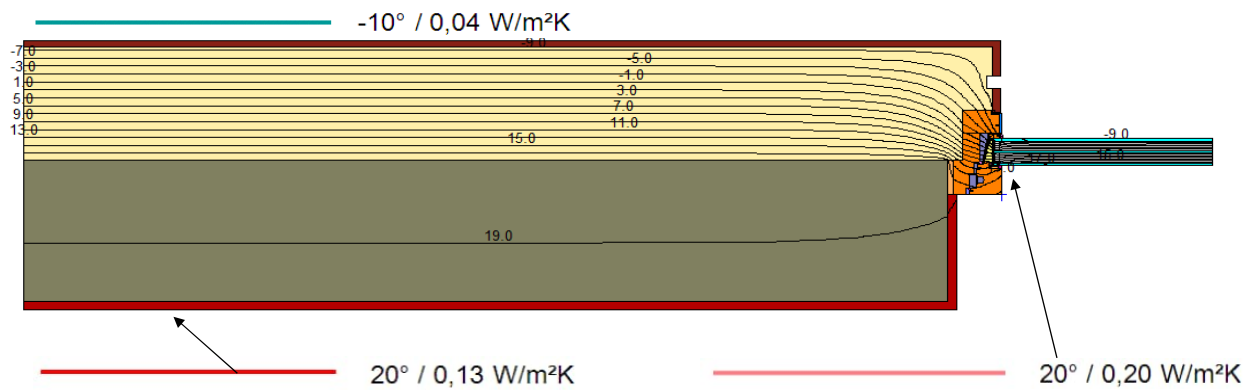

Project

Date 01.08..2018

Signature

F. F. F.

smartwin solar EIFS concrete (WDVS Beton)
venetian blind (Rafflamelle), blindframe (Blindstock)



U_{1D} Wall	0,167	W/m ² K
U_{2D} Window	0,756	W/m ² K
U_{2D}	0,303	W/m ² K

Length S1	1,500	m
Length S2	0,400	m
Total length	1,900	m

L_{1D}	0,552	W/mK
L_{2D}	0,575	W/mK

Ψ_e	0,023	W/mK
----------	-------	------

projected X
projected X

PHI				
Boundary Conditions	R_s	θ	R_s	θ
	0,13	20,00	0,25	20,00
	0,13	20,00	0,20	20,00
	0,04	-10,00	0,04	-10,00
Psi-value			fR_{si}	

lowest interior temperature:
 f_{RSI} at 20 °C / -10 °C

12,7°C
0,76

> 0,7 requirement fulfilled

Isotherms:

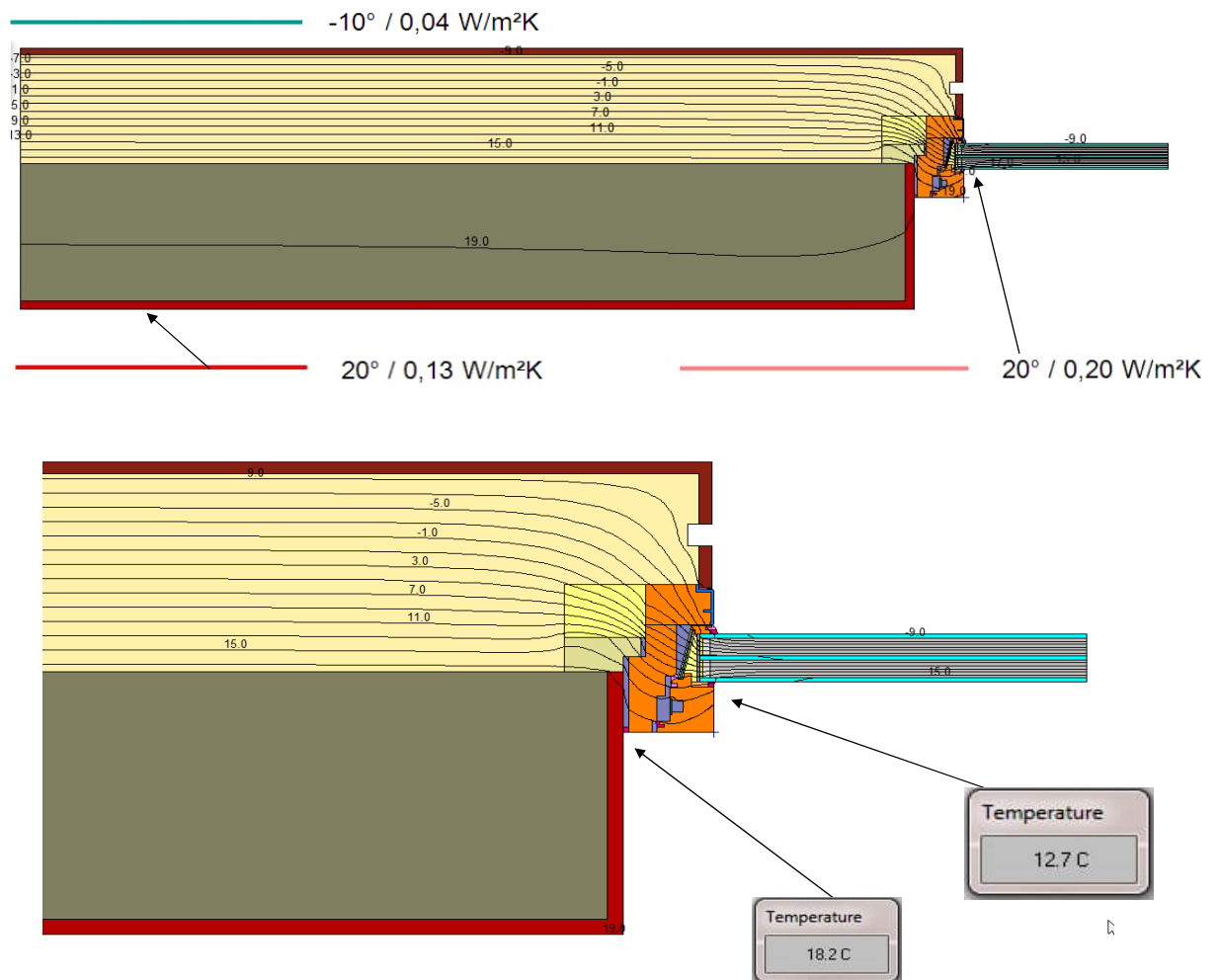

Project

Date 01.08.2018

Signature

F. F. F.

smartwin solar EIFS concrete (WDVS Beton)

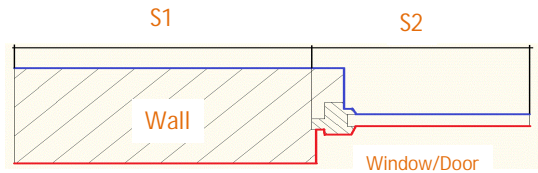



U_{1D} Wall	0,167	W/m ² K
U_{2D} Window	0,779	W/m ² K
U_{2D}	0,309	W/m ² K

Length S1	1,500	m
Length S2	0,400	m
Total length	1,900	m

L_{1D}	0,562	W/mK
L_{2D}	0,588	W/mK

Ψ_e	0,026	W/mK
----------	-------	------

projected X
projected X

PHI				
Boundary Conditions	R_s	θ	R_s	θ
	0,13	20,00	0,25	20,00
	0,13	20,00	0,20	20,00
	0,04	-10,00	0,04	-10,00
Psi-value			fR_{si}	

lowest interior temperature:
 f_{RSI} at 20 °C / -10 °C

12,3°C
0,74 > 0,7 requirement fulfilled

Isotherms:

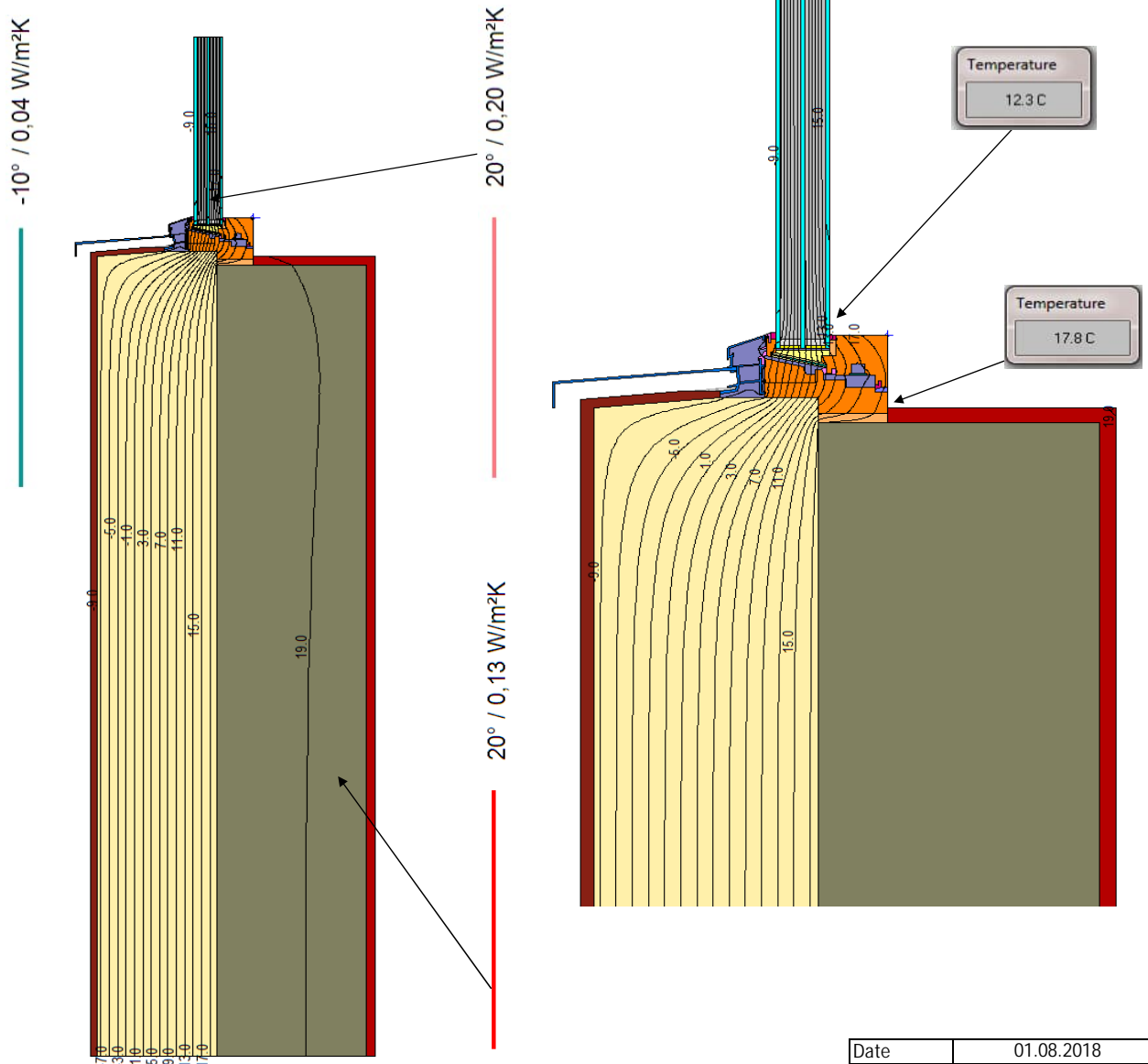

Date	01.08.2018
Signature	

smartwin solar EIFS concrete (WDVS Beton)
blindframe (Blindstock)



U_{1D} Wall	0,167	W/m ² K
U_{2D} Window	0,779	W/m ² K
U_{2D}	0,316	W/m ² K

Length S1	1,500	m
Length S2	0,400	m
Total length	1,900	m

L_{1D}	0,562	W/mK
L_{2D}	0,600	W/mK

Ψ_e	0,039	W/mK
----------	-------	------

projected X
projected X

PHI				
Boundary Conditions	R_s	θ	R_s	θ
	0,13	20,00	0,25	20,00
	0,13	20,00	0,20	20,00
	0,04	-10,00	0,04	-10,00
Psi-value			fR_{si}	

lowest interior temperature:
 f_{RSI} at 20 °C / -10 °C

12,5°C
0,75

> 0,7 requirement fulfilled

Isotherms:

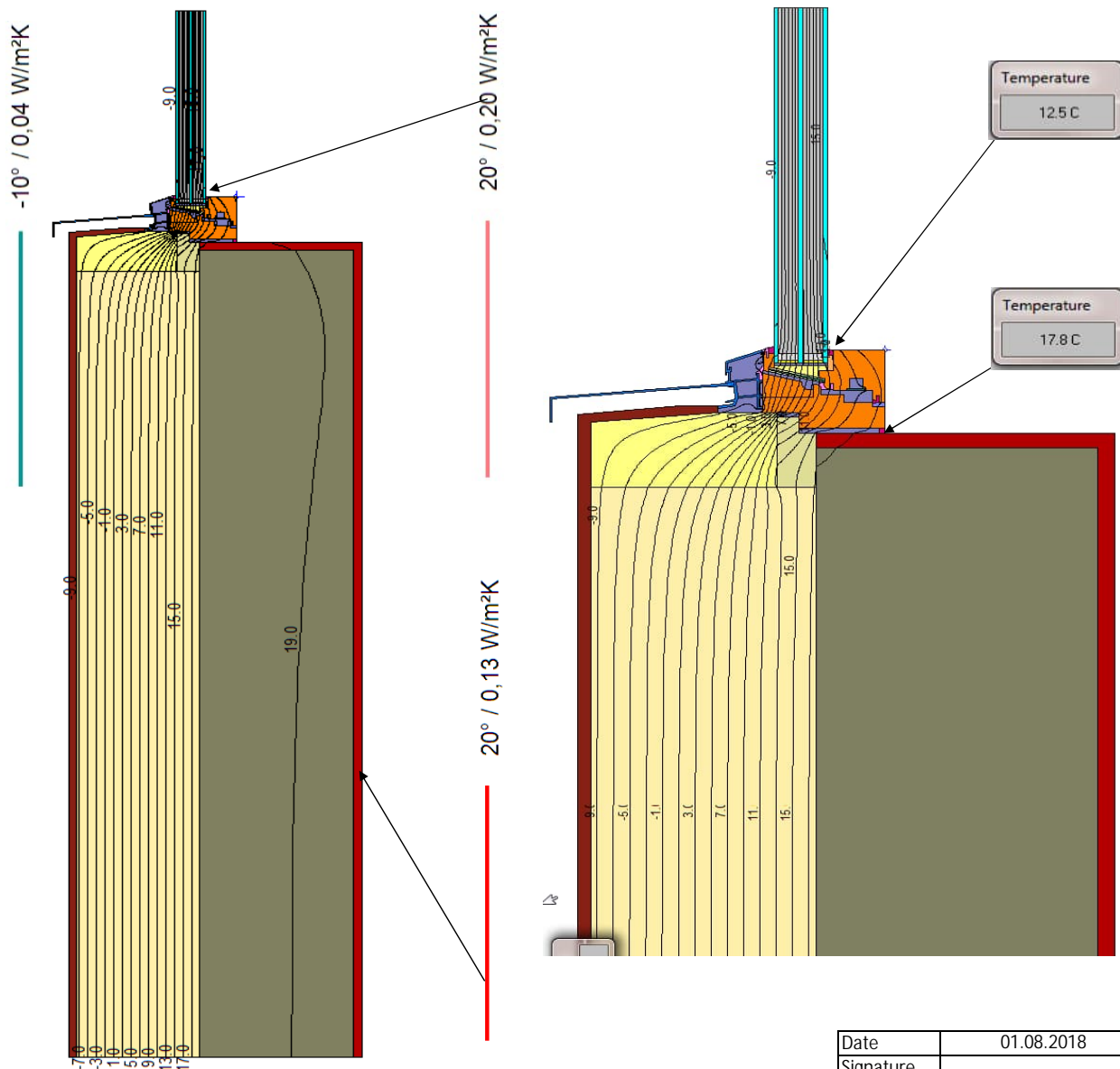

Date	01.08.2018
Signature	



smartwin solar EIFS concrete (WDVS Beton)
venetian blind (Rafflamelle), blindframe (Blindstock)

U _{1D} Wall	0,167	W/m ² K
U _{1D} Ceiling	0,108	W/m ² K
U _{2D} Window	0,789	W/m ² K
U _{2D}	0,172	W/m ² K

Length S1	1,005	m
Length S2	0,400	m
Length S3	3,015	m
Total length	4,020	m

L _{1D} Wall	0,101	W/mK
L _{1D} Ceiling	0,271	W/mK
L _{2D} window	0,315	W/mK
L _{2D}	0,691	W/mK

Ψ _e	0,004	W/mK
----------------	-------	------

lowest interior temperature:
f_{RSi} at 20 °C / -10 °C

projected X
custom length (S1+S3) entspricht D21

PHI				
Boundary Conditions	R _s	θ	R _s	θ
	0,13	20,00	0,25	20,00
	0,17	20,00	0,25	20,00
	0,13	-10,00	0,04	-10,00
	0,17	-5,00	0,04	-5,00
	0,13	-5,00	0,04	-5,00
Psi-value			fR _{si}	

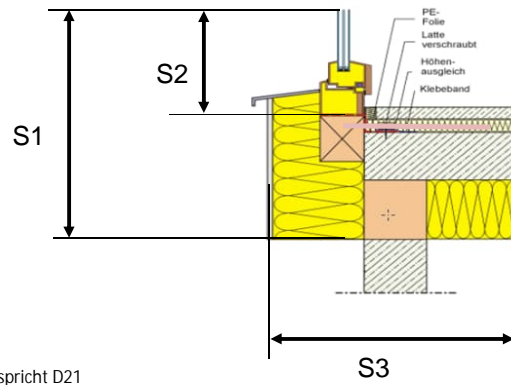

-10° / 0,04 W/m²K

Isotherms:

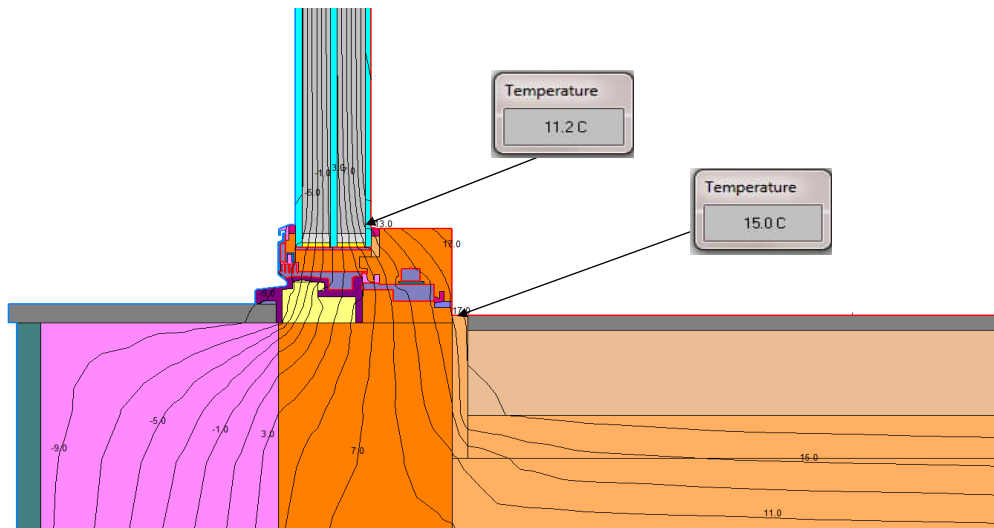
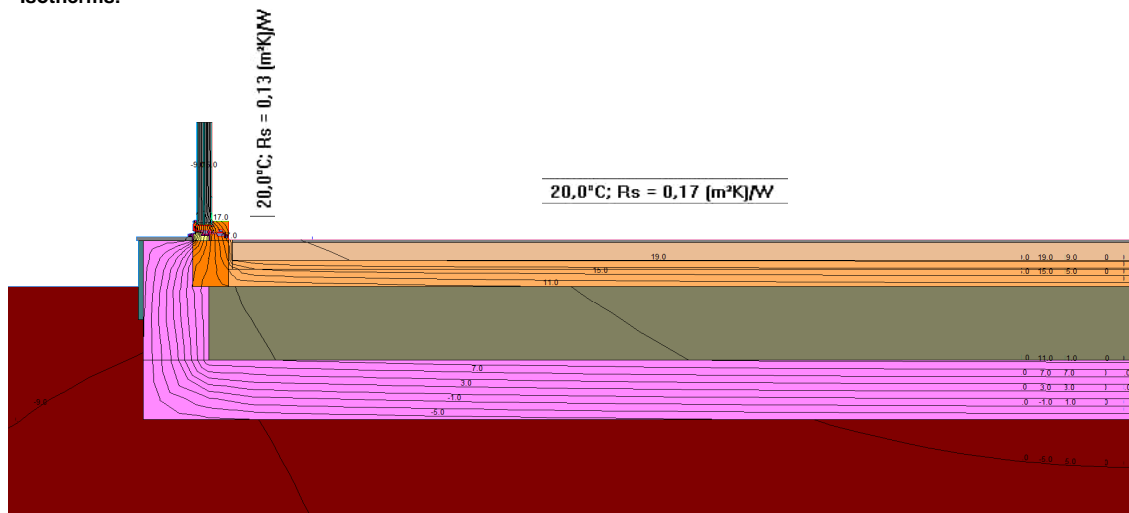

Date 01.08.2018
Signature

F. Fiedler